



DOUGHTY ENGINEERING LTD

DATA SHEET

TITLE: TV LIGHTING SPIGOT 29MM X 16MM STEEL (EURO SPEC)

PART NOS:
G1190

MATERIAL:
STEEL

WEIGHT:

SWL:

FINISH:
CHROME PLATED

NOTES:

STRICTLY FOR REFERENCE PURPOSES ONLY



THIRD ANGLE PROJECTION

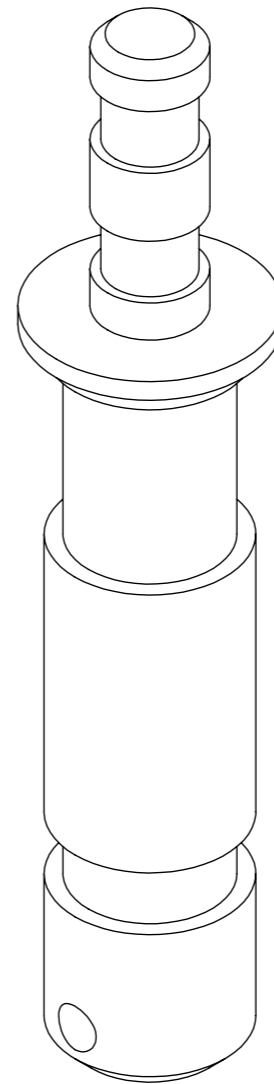
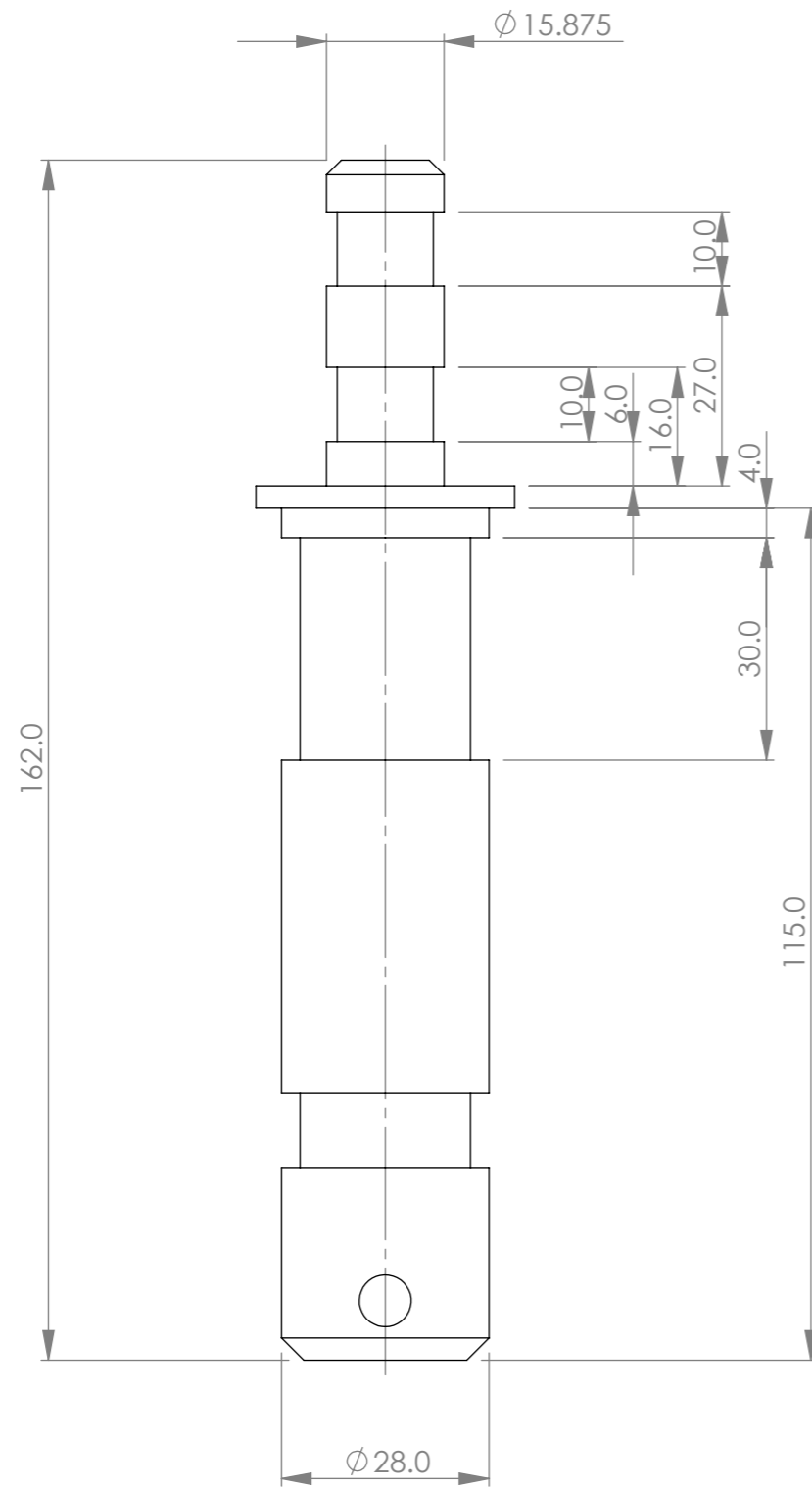



DOUGHTY ENGINEERING LTD

DATA SHEET

TITLE: TV LIGHTING SPIGOT 29MM X 16MM STEEL (EURO SPEC)

PART NOS:
G1191

MATERIAL:
ALUMINIUM

WEIGHT:

SWL:

FINISH:
POLISHED

NOTES:

STRICTLY FOR REFERENCE PURPOSES ONLY

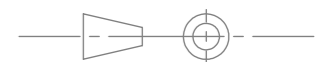

THIRD ANGLE PROJECTION

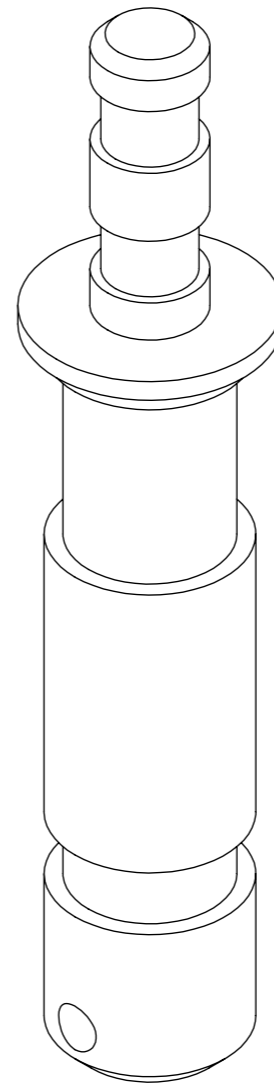
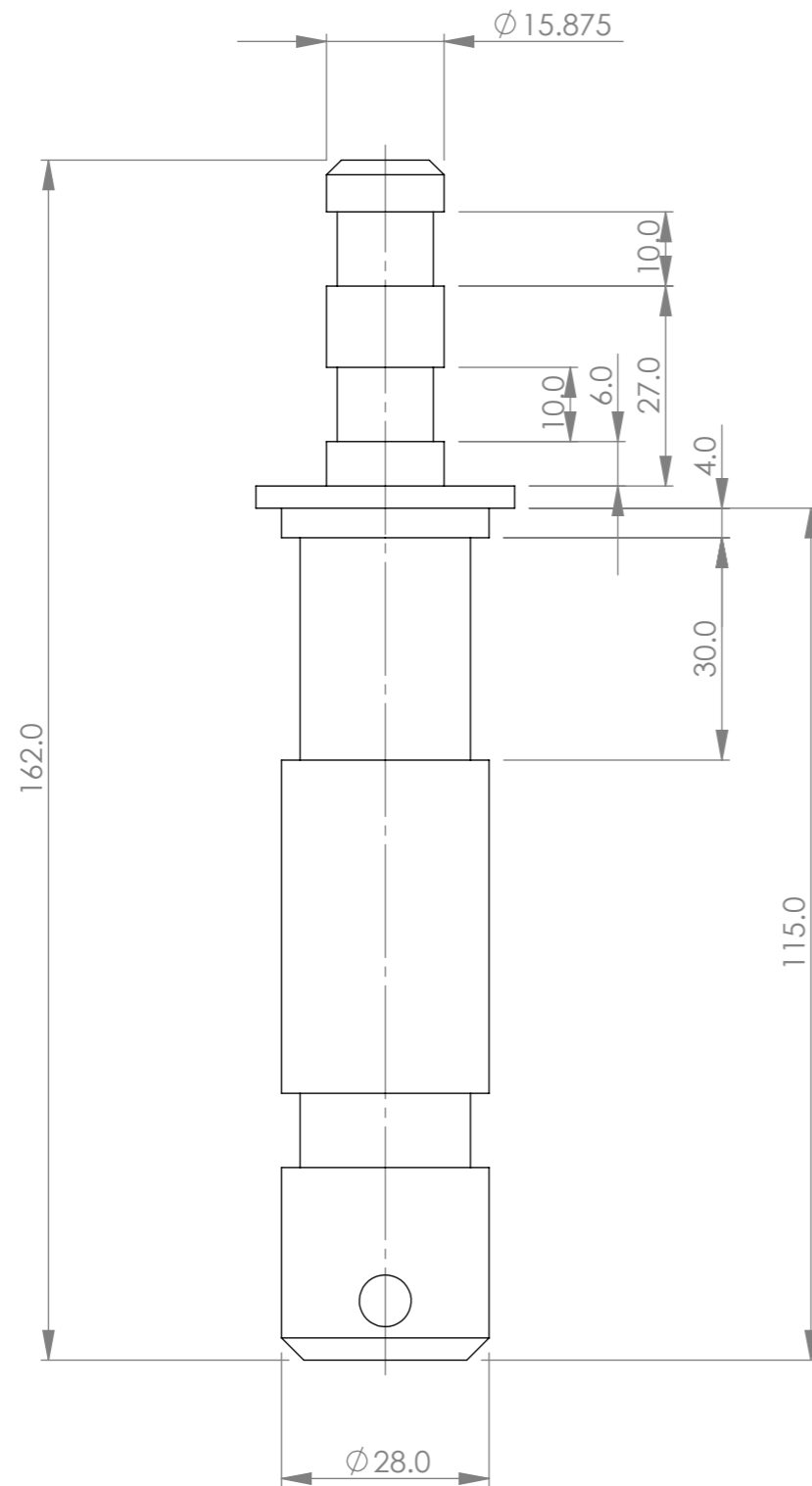



DOUGHTY ENGINEERING LTD

DATA SHEET

TITLE: TV LIGHTING SPIGOT 29MM X 16MM STEEL (DIN SPEC)

PART NOS:

G1193

MATERIAL:

WEIGHT:

STEEL

SWL:

FINISH:

CHROME PLATED

NOTES:

STRICTLY FOR REFERENCE PURPOSES ONLY



THIRD ANGLE PROJECTION

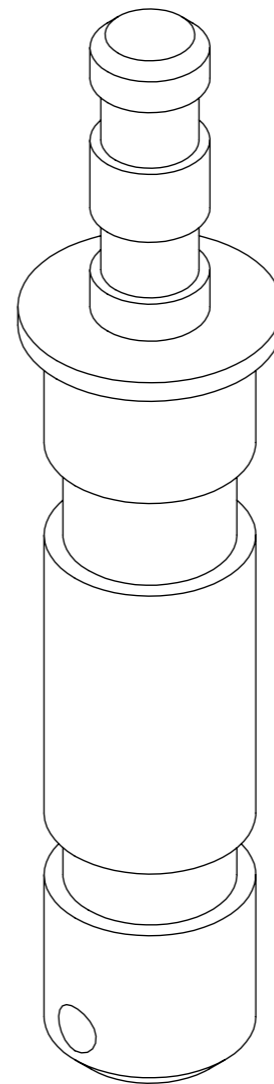
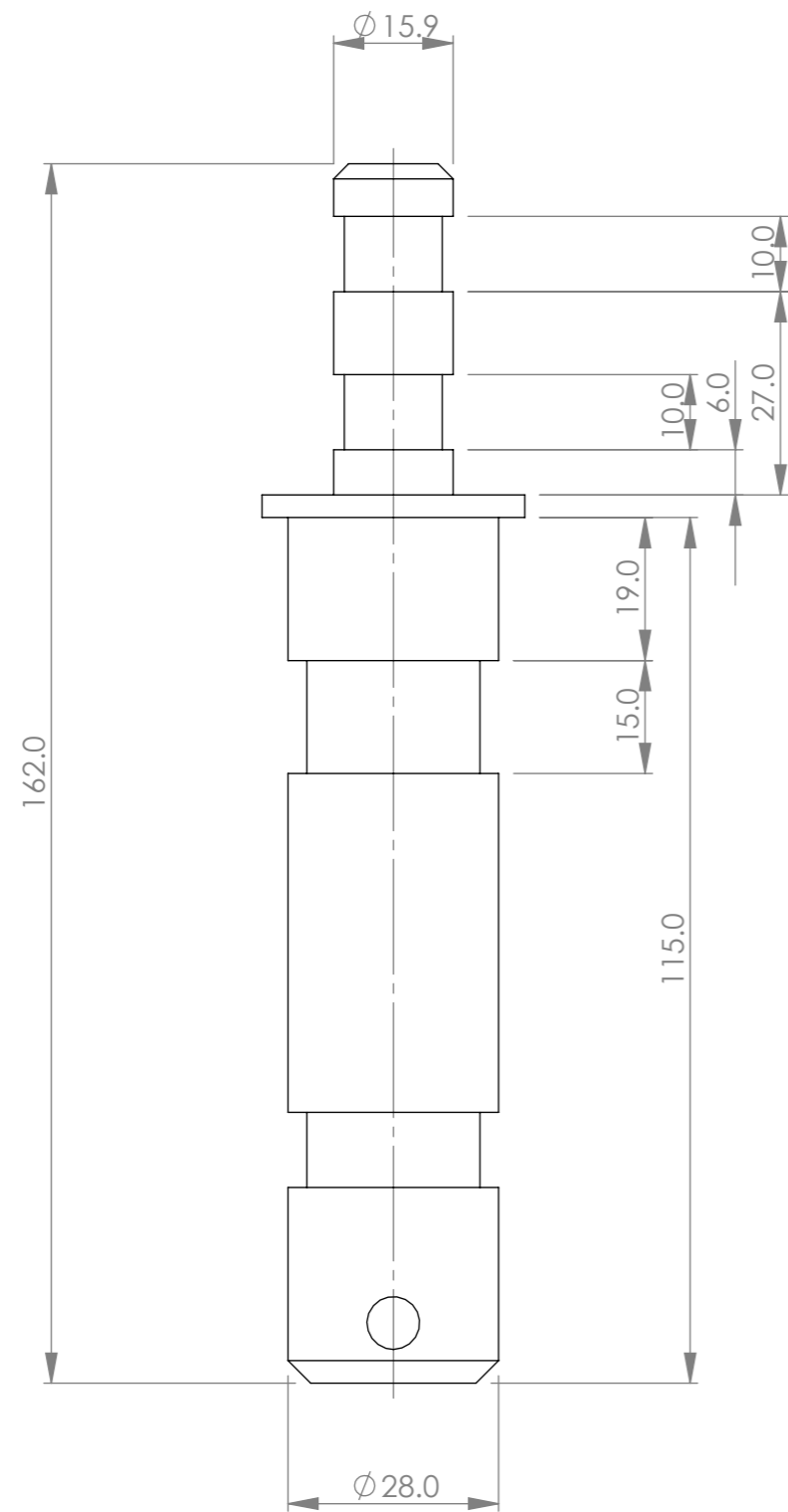



DOUGHTY ENGINEERING LTD

DATA SHEET

TITLE: TV LIGHTING SPIGOT 29MM X 16MM (DIN SPEC)

PART NOS:

G1194

MATERIAL:

WEIGHT:

ALUMINIUM

SWL:

FINISH:

POLISHED

NOTES:

STRICTLY FOR REFERENCE PURPOSES ONLY



THIRD ANGLE PROJECTION

