



AF-10/AF-14
Special Effects Fan
User Manual
- English
- 中文





1.	Introduction	1
2.	Safety Information	1
3.	Package Contents & Inspection	2
4.	Machine Details	3
5.	Technical Label Information	3
6.	Setting and Manual Operation	3
7.	Service and Maintenance.....	4
8.	Technical Specifications	4
9.	Warranty Disclaimer	4
10.	Machine Dimension	4
1.	前言	6
2.	安全注意事項	6
3.	包裝內容與檢查	7
4.	機器訊息.....	8
5.	技術標籤資訊	8
6.	設定與手動操作說明.....	8
7.	維護和保養	9
8.	技術規格.....	9
9.	保固聲明.....	9
10.	機器尺寸圖	10
	Appendix I - Grounding Instruction	11

User Manual

1. Introduction

Please read all the user manual before operating the machine, and place the manual where the user can refer to it at all time. The manual includes how to install and operate the machine under safe condition and explain all the labels printed on the machine. If you encounter any problem, contact your local Antari dealer for assistant immediately.

2. Safety Information

	DANGER	If the danger is not avoided, it will cause death or serious injury
	WARNING	If the warning is not heeded, it can cause death or serious injury.
	CAUTION	If the precaution is not taken, it may cause minor or moderate injury.



DANGER

- Must connect the machine to the correct rated voltage or it might lead to an electrical shock or a burn and may cause serious consequences.
- Must connect the machine to a protected circuit and ensure it is properly grounded to avoid the risk of electrocution. For grounding instruction, please refer to Appendix I on page 11.
- Do not operate the machine with a bundled power cord, it could lead to a fire hazard.
- Do not use the fan in an environment full of flammable gas, susceptible to water or powder. Keep away from any fire and heat sources.
- When operating the machine, do not point at people, animals, or fire.



WARNING

- Please operate the machine on a flat, level hard and well ventilated surface area, reserve at least 50cm space around the machine and make sure there is no flammable gas or material nearby.
- Do not disassemble, repair or modify the machine, it may cause damages, malfunction, risk of electrical shock or result in fire.
- The machine can only be operated by adults or professionals, is not intended for use by person with reduced physical sensory, mental capabilities, or lack of experience and knowledge including children.
- Do not leave the machine running unattended, make sure all powers are off when leaving.
- Children should be supervised to ensure that they do not play with the machine.
- Do not use the machine upside down or tilt it, it might cause damages or malfunction.
- Never allow any object or part of your body to enter path of the fan blades to prevent any injury or damages
- Do not spray the fan with any liquid including cleaner and insecticide to avoid injury or damages.



CAUTION

- The machine is water splash resistance, do not expose the machine to poor drainage environment or soak in the water.
- Please make sure the power outlet is not damaged or loose before plug in the power cord.
- If the power cord is damaged, it must be replaced by Antari or its local dealers, otherwise the warranty will be void.
- Do not operate the machine in any area with unstable voltage.
- If you experience strange sound or malfunction, turn off the power and unplug the power cord immediately and contact your local Antari dealer for assistant.

- Do not contact any moving part.
- Only use accessories recommended or sold by Antari.
- Please make sure the power is off when not using the machine and unplug the power cord if not intend to use for a long period of time.
- To disconnect, turn all controls to the off position, then remove plug from outlet.
- Do not unplug by pulling on cord. To unplug, grasp the plug, not the cord.
- Unplug from outlet before servicing or cleaning.
- Ensure that curtain, clothing, cables or other items cannot be suck into the fan.
- Do not operate the machine with a damaged cord or plug, or after the machine malfunctions or is dropped or damaged in any manner. Return machine to the nearest authorized service facility for examination, repair, or electrical or mechanical adjustment.
- After a period of operation, abnormal noise and uneven air volume may appear because of dust blocking airflow. It will disappear after cleaning the air inlet and outlet.



IP55 RATED

The **International Protection (IP)** rating system is commonly expressed as “**IP**” (Ingress Protection) followed by two numbers (i.e. IP55), where the numbers define the degree of protection. The first digit (Foreign Bodies Protection) indicates the extent of protection against particles entering the fixture, and the second digit (Water Protection) indicates the extent of protection against water entering the fixture. An **IP55** rated machine is designed and tested to protect against the ingress of dust (5), and low-pressure water jets from any direction (5).

NOTE: THE MACHINE IS INTENDED FOR TEMPORARY OUTDOOR USE ONLY!

Warning

- Keep all body parts, clothing, tools, and other objects clear of moving parts at all times.
- Do not block or obstruct airflow from the front or rear of the fan.
- Children and untrained persons must not operate the fan.
- Do not expose the unit to heavy rain, moisture, or excessively dusty environments.
- No user severiceable part inside
- Use only authorized accessories or control devices specified by the manufacturer.

3. Package Contents & Inspection

Immediately upon receiving the machine, carefully unpack the carton, check the content to ensure it is the correct model and all parts are included. If any part appears to be damaged or missing during transportation, please contact your local dealer and return with original package for inspection.

3.1 Package Contents

AF-10	AF-14
1 x AF-10 Special Effects Fan	1 x AF-14 Special Effects Fan
1 x Power Cable with SEETRONIC IP65 Connector	1 x Power Cable with SEETRONIC IP65 Connector
1 x Dual Use Bracket	1 x Dual Use Bracket
1 x Quick Start Guide	1 x Quick Start Guide

3.2 Optional Accessories

Item Code	Description
AFC-1	Fan Control Box

4. Machine Details

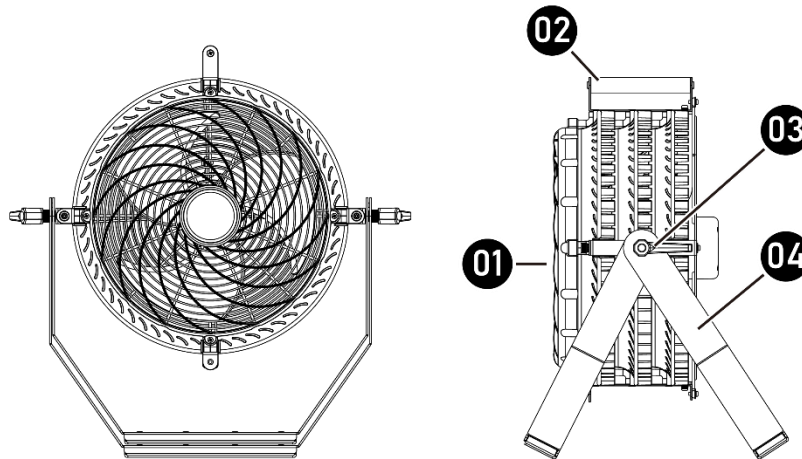

01. Wind Outlet	03. Adjusting Knob
02. Handle	04. Dual Use Bracket

5. Technical Label Information

Please read the technical label information on the back of the machine before operating it.

1. Model Name	5. Breaker/Fuse
2. Input Voltage	6. QR CODE for User Manual
3. Frequency	7. Serial No.
4. Rated Power	

6. Setting and Manual Operation

- Step 1.** Place the machine on a flat, level hard and well ventilated surface area and reserve at least 50cm open space around the machine, and make sure there is no flammable gas or material nearby;
- Step 2.** Plug the machine to the power outlet. Please read the technical label on the back of the machine and make sure the power outlet has the correct rated voltage for the machine;
- Step 3.** Plug in to turn on the fan and unplug to turn off the fan.

Bracket Installation Instruction:

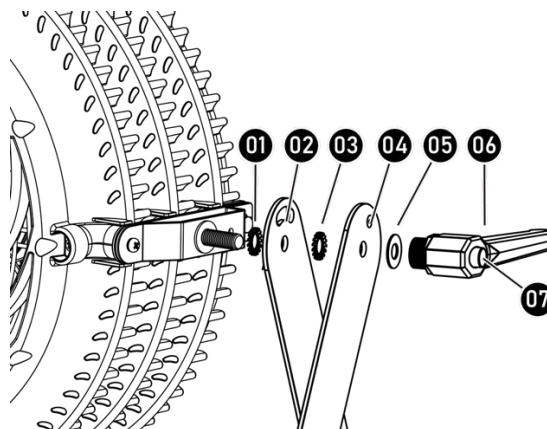

- Step 1.** Please follow the sequence 01 – 06 to install the bracket for both sides
Step 2. When push the button (07) on the lever, you can rotate the handle to any angles.

7. Service and Maintenance

	DANGER	Disconnect the power cord before starting maintenance operation!
---	---------------	--

- Always keep the machine clean.
- Can use an air compressor, a lower pressure water jet, a vacuum or a soft brush to remove the dust on the machine.
- Can use a slightly damp cloth to clean the casing.
- It is recommended to run the machine at least once a month in order to maintain its best performance and output condition.
- Excessive dust will reduce the performance and cause overheat.

8. Technical Specifications

	AF-10	AF-14
Rated Voltage	US Model : AC 100-120V, 50/60Hz 0.5A EU Model : AC 220-240V, 50/60Hz 0.5A	US Model : AC 100-120V, 50/60Hz 2.0A EU Model : AC 220-240V, 50/60Hz 1.0A
Rated Power	120V 60W / 240V 65W	120V 190W / 240V 145W
Ambient Temp. Range	0°C – 40°C (32°F – 104°F)	
Air Flow	1913 CFM (AC 120V/60Hz)	3826 CFM (AC 240V/60Hz)
Fan Speed	1643 rpm (50Hz) 1672 rpm (60Hz)	1609 rpm (50Hz) 1678 rpm (60Hz)
Noise Level	51.0 dB (Max. Output)	59.0 dB (Max. Output)
Control Methods	N/A	
DMX Channel	N/A	
Interface	SEETRONIC IP65 Connector (Power)	
Included Accessories	Dual Use Bracket	
Optional Accessories	AFC-1 Control Box	
Dimension	L 534 W 327 H 515 mm (L 21.03 W 12.87 H 20.28 inch)	L 654 W 433 H 672 mm (L 25.75 W 17.05 H 24.46 inch)
Weight	6.9 kg (15.22 lbs.)	13.5 kg (29.77 lbs.)

9. Warranty Disclaimer

We guarantee the merchandise manufactured by us to be free from defect in material and workmanship for a period of one year. Our obligation and liability under this warranty shall be restricted to repair or replacement at our factory or local authorized dealer. We assume no liability of the products that are improperly used or used for any purpose other than that for which they are specially designed. This warranty shall not apply to any merchandise which has been repaired, altered or assembled outside our factory in any way so as in our judgment to affect its performance, nor which has been subjected to misuse, negligence, or accident nor to any merchandise operated contrary to our printed instructions. We will not allow or be liable of any loss or any damages of any kind in connection with the use, sale, or repair of any merchandise purchased from us.

10. Machine Dimension

AF-10

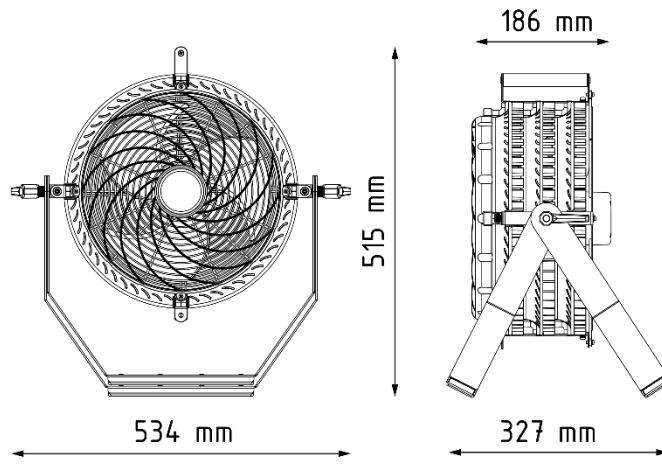

AF-14

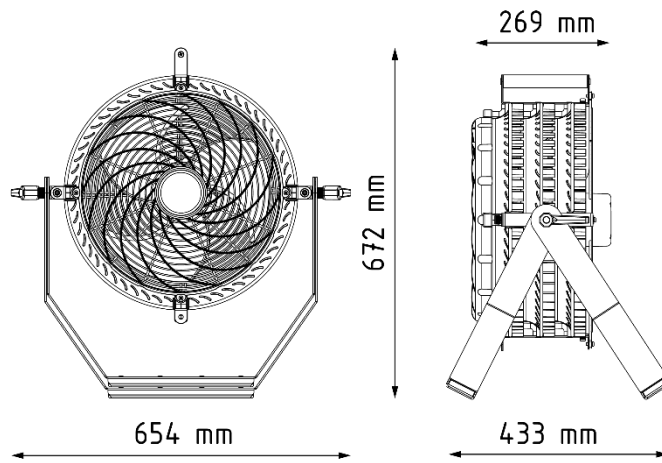



ANTARI AF-10 AF-14

中文使用說明書

1. 前言

在操作本機器之前，請務必仔細詳閱本說明書然後請將本說明書放置在機器使用者可隨時查閱之處存放。此說明書包含如何安全的安裝及操作本機器以及說明所有在機器上的標示。如果您有任何操作上的問題，請立即聯繫當地的 Antari 經銷商尋求協助。

2. 安全注意事項

 危險	若不確實避免這些指示，可能導致嚴重人身傷害甚至死亡。
 警告	若不確實遵循這些指示，可能導致嚴重人身傷害甚至死亡。
 注意	若不確實注意這些指示，可能導致人身傷害甚至死亡，嚴重程度視情況而定。

危險

- 請務必使用正確電壓。如果使用錯誤電壓，可能會遭受危險的電擊燒傷或更嚴重的後果。
- 請務必將機器連結到有保護的電路，並確保有正確地接地，以避免觸電的危險。關於接地方式請參考第 11 頁附錄 I。
- 請勿在捆綁電源線的情況下使用，可能會發熱導致火災。
- 禁止在有易燃氣體、易被水淋、粉塵較多的地方使用風扇。請遠離火源及熱源。
- 操作機器時請勿將機器對著人體、動物或火焰使用。

警告

- 請於堅固、平坦、穩定且通風良好的表面上使用機器。請勿遮蓋機器散熱部份，機器周邊至少應保留公分的空間並確認附近沒有易燃性物質或可揮發性氣體。
- 請勿隨意拆卸、修理或改造機器，這可能會導致機器故障、損壞、觸電危險或造成火災。
- 本機器僅限有行為能力之成人或專業人員操作，不預期提供生理、感知、心智能力、經驗或知識不足者之使用者(包含孩童)使用本機器。
- 請勿在無人看管時讓機器運作，並於外出離去時確實關閉電源。
- 孩童應受監督，以確保孩童不能操作或嬉戲玩本機器。
- 請勿將機器倒放或傾斜使用，可能導致機器動作不正常或損壞。
- 禁止將其他物體或身體部位插入前後網內，避免受傷或損壞。
- 請勿將任何液體包含清潔劑與殺蟲劑等，噴向風扇避免受傷或損壞。

注意

- 本機器為防潑水設計，嚴禁將其浸水或放在排水不良易積水的環境。
- 在插入電源插座前，請確認電源插座無損壞或鬆動。
- 若電源線損壞，必須使用原廠電源線或組件進行更換，否則將導致保固無效。
- 請勿在電壓不穩定的地區使用本機器。
- 如果機器出現異常聲音或有任何不正常現象時，請立即停止工作，將電源關閉及拔下機器電源線，並請聯繫當地的 Antari 經銷商尋求協助。
- 請勿觸碰機器內部運轉零件。

- 只能使用原廠建議或販售之配件。
- 請確認機器不在使用的狀態下電源已關。如果長時間不使用機器，請拔掉電源線。
- 關閉機器時，將所以控制開關轉到關閉的位置，然後再將插頭從插座拔除。
- 拔除電源線時，請抓住插頭不是電線。
- 應遠離窗簾、衣物、電線或其他異物，避免被風扇葉片捲入。
- 在保養及清潔前，請把電源線從插座拔除。
- 在電線或插座有損毀、機器故障或有掉落或損壞的情形發生時，請勿操作機器。請將機器送回最近的維修站，做檢查、維修及電源或機械的調整。
- 使用一段時間後，因為灰塵阻擋空氣流動，有可能會產生異音或不均勻風量。在清潔過後就會恢復正常。



IP55 防護等級

國際防護 (IP) 等級系統通常表示為「IP」(防護等級)，後面跟隨兩個數字 (例如 IP55)，這些數字定義了防護程度。第一個數字 (防異物保護) 表示對進入設備的顆粒的防護程度，第二個數字 (水防護) 表示對水進入設備的防護程度。IP55 防護等級的機器經過設計和測試，可防止灰塵 (5) 的進入，並能承受來自各個方向的低壓水流 (5)。

注意：此機器僅適用於臨時戶外使用！

警告！

- 請勿將身體部位、衣物、工具或其他物品接近風扇運轉部位。
- 請勿遮擋或阻塞風扇前後的氣流出口。
- 兒童及未受訓人員不得操作本風扇。
- 請勿將本設備暴露於大雨、潮濕或過於多塵的環境中。
- 本設備內部無使用者可維修部件。
- 僅使用製造商指定的授權配件或控制裝置。

3. 包裝內容與檢查

在收到機器後，請立即小心地打開包裝紙箱，檢查所有內容，確認您所購買的機型及配件。如果有任何部件因運輸過程出現損壞或缺少，請立即連絡經銷商，並以原包裝退回檢查。

3.1 包裝內容

AF-10	AF-14
1 x AF-10 特效風扇	1 x AF-14 特效風扇
1 x SEETRONIC IP65 接頭電源線	1 x SEETRONIC IP65 接頭電源線
1 x 雙用支架	1 x 雙用支架
1 x 簡易說明書	1 x 簡易說明書

3.2 選配說明

品項	描述
AFC-1	風扇控制盒

4. 機器訊息

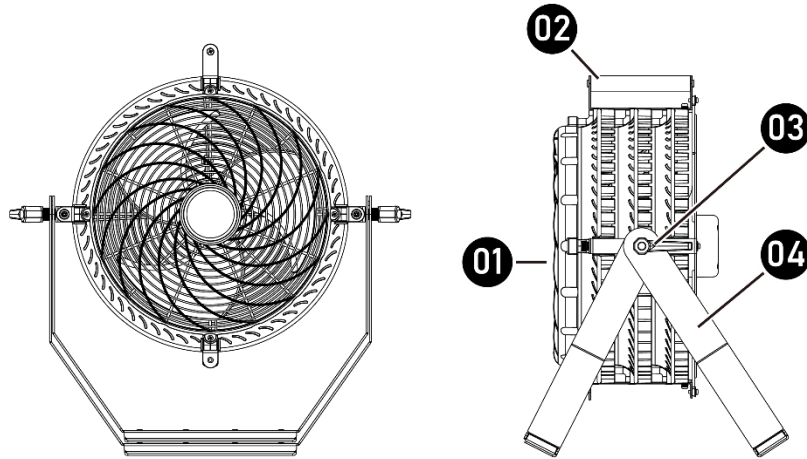

01. 出風口	03. 調整旋鈕
02. 把手	04. 雙用支架

5. 技術標籤資訊

使用本機器前，請詳閱位於機器後方的技術標籤訊息。

1. 機器型號	5. 斷路器/保險絲
2. 工作電壓	6. 說明書 QR CODE
3. 頻率	7. 機器流水序號
4. 瓦特數	

6. 設定與手動操作說明

- 步驟1.** 將機器平放在堅固、平坦、穩定且通風良好的表面上，機器周圍至少應保留 50 公分的空間並確認附近沒有易燃性物質或可揮發性氣體；
- 步驟2.** 將機器連接電源插座，連接之前，確認機器背後技術標籤上所標示要求功率，是否與電源插座相符；
- 步驟3.** 插入插頭啟動風扇，拔開插頭關閉風扇。

吊架安裝說明：

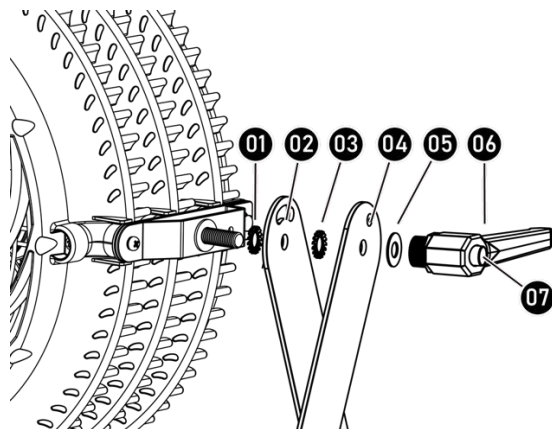

步驟1. 請依照順序 01 至 06 安裝兩側的支架。

步驟2. 當按下手把上的按鈕(07)時，可以將手柄旋轉至任意角度。

7. 維護和保養



危險

維修保養之前，請務必拔除電源線！

- 隨時保持機器清潔。
- 可以使用空氣壓縮機、低壓水柱、吸塵器或軟刷除去機器上的灰塵。
- 機殼可使用濕布擦拭。
- 建議每月至少讓機器運轉一次，以保持機器處於最佳的性能和輸出條件。
- 機器上過多的灰塵會降低機器工作性能，導致散熱不良。

8. 技術規格

	AF-10	AF-14
額定電壓	美規 : AC 100-120V, 50/60Hz 0.5A 歐規 : AC 100-120V, 50/60Hz 0.5A	美規 : AC 100-120V, 50/60Hz 2.0A 歐規 : AC 100-120V, 50/60Hz 1.0A
額定功率	120V 60 瓦 / 240V 65 瓦	120V 190 瓦 / 240V 145 瓦
適用環境溫度	0°C – 40°C (32°F – 104°F)	
風量	1913 立方英尺/分(AC120V/60 赫茲)	3826 立方英尺/分(AC240V/60 赫茲)
風扇速度	1643 轉(50 赫茲) 1672 轉(60 赫茲)	1609 轉(50 赫茲) 1678 轉(60 赫茲)
噪音值	51.0 分貝(最大輸出)	59.0 分貝(最大輸出)
控制方式	無	
DMX 頻道	無	
連接座	SEETRONIC IP65 Connector (主電源)	
隨附配件	雙用支架	
選購配件	AFC-1 控制盒	
尺寸	長 534 寬 327 高 515 公釐 (長 21.03 寬 12.87 高 20.28 英寸)	長 654 寬 433 高 672 公釐 (長 25.75 寬 17.05 高 26.46 英寸)
重量	6.9 公斤 (15.22 磅)	13.5 公斤 (29.77 磅)

9. 保固聲明

本公司保證我們的商品在一年內沒有材料和製作缺陷。我們在本保證下的義務和責任僅限於在原廠或當地授權經銷商進行的維修或更換。我們對不當使用或用於非專門設計目的以外之用途不承擔任何責任。本保固不適用於以任何方式在原廠或當地授權經銷商外修理、改動或組裝的任何商品，以便我們判斷影響其性能，沒有受到誤用、疏忽或事故的影響，也沒有違反我們的任何商品操作印刷說明。本公司對於從我們這邊購買的商品不會允許也不對於使用、銷售或修理任何產品有關的任何類型的任何損失或損害承擔責任。

10. 機器尺寸圖

AF-10

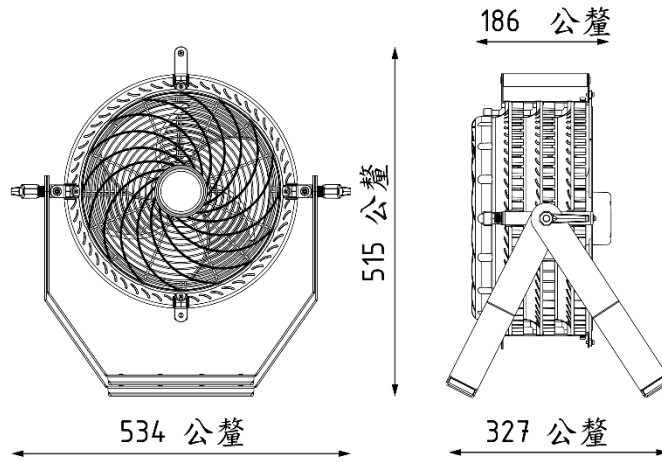

AF-14

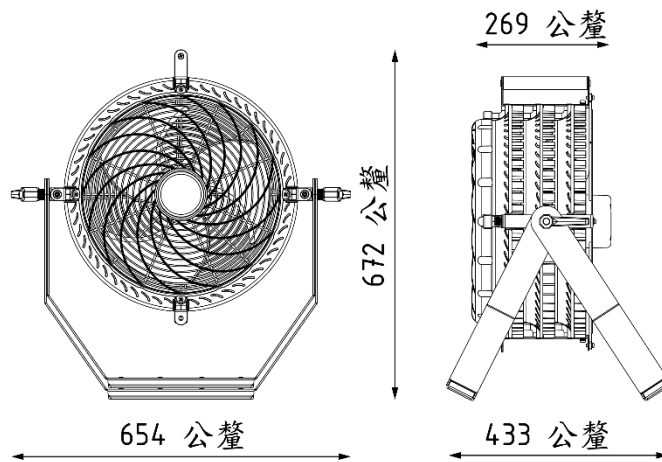

Appendix I - Grounding Instruction

This appliance must be grounded. In the event of malfunction or breakdown, grounding provides a path of least resistance for electric current to reduce the risk of electric shock. This appliance is equipped with a cord having an equipment-grounding conductor and a grounding plug. The plug must be plugged into an appropriate outlet that is properly installed and grounded in accordance with all local codes and ordinances.

DANGER – Improper connection of the equipment-grounding conductor can result in a risk of electric shock. The conductor with insulation having an outer surface that is green with or without yellow stripes is the equipment-grounding conductor. If repair or replacement of the cord or plug is necessary, do not connect the equipment-grounding conductor to a live terminal. Check with a qualified electrician or serviceman if the grounding instructions are not completely understood, or if in doubt as to whether the appliance is properly grounded. Do not modify the plug provided with the appliance – if it will not fit the outlet, have a proper outlet installed by a qualified electrician.

This appliance is for use on a nominal 120V circuit, and has a grounding plug that looks like the plug illustrated in sketch A in Figure. A temporary adaptor, which looks like the adaptor illustrated in sketches B and C, may be used to connect this plug to a 2-pole receptacle as shown in sketch B if a properly grounded outlet is not available. The temporary adaptor should be used only until a properly grounded outlet can be installed by a qualified electrician. The green colored rigid ear, lug, and the like, extending from the adaptor must be connected to a permanent ground such as a properly grounded outlet box cover. Whenever the adaptor is used, it must be held in place by the metal screw.

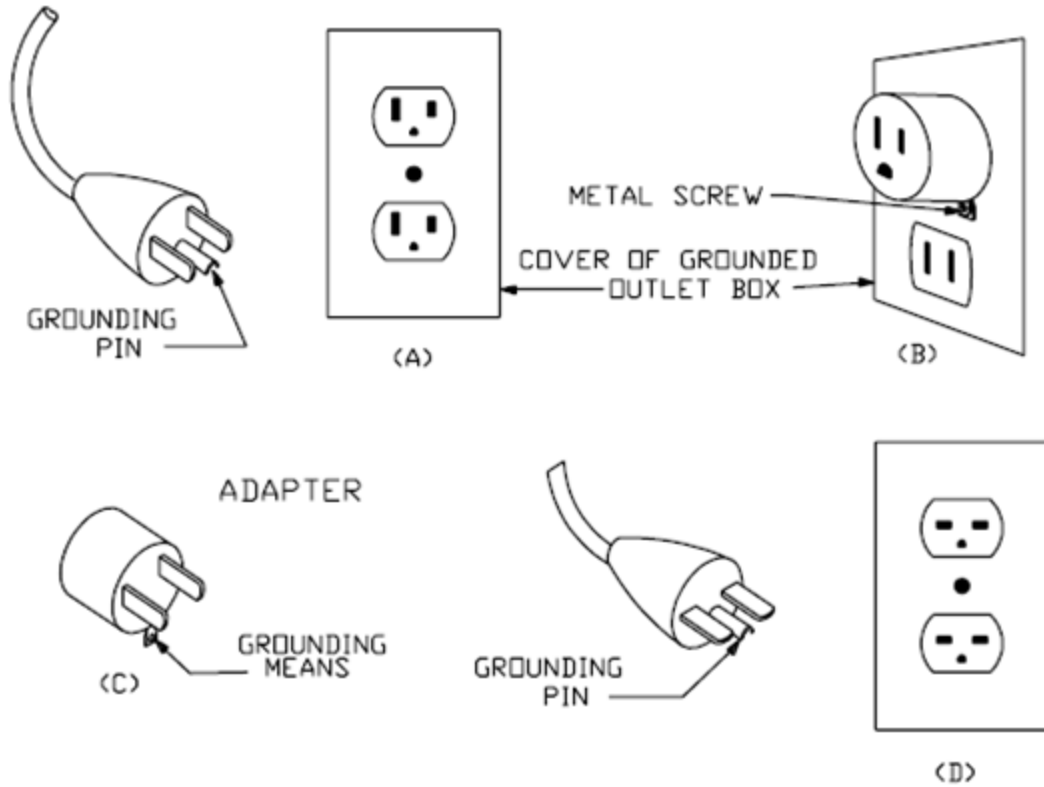



C08AF1000